

Bavaria 37 Sport



Lots of improvements coming with the new 37 Sport which replaces the models Bavaria 35 Sport and the Bavaria 38 Sport.

Brixham Marina, Brixham, Devon. TQ5 9BP

Tel: 01803 853843 - Email: sales@plainsailing.co.uk

Technical Details & Layouts

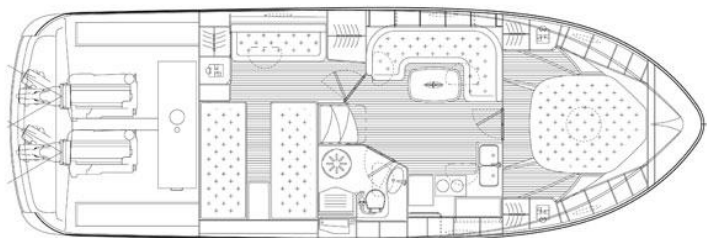

Internal Layout

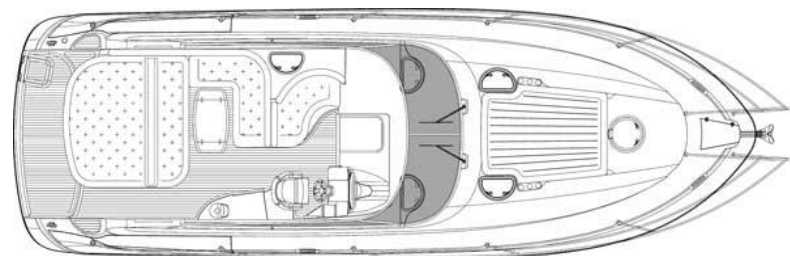

Deck Layout

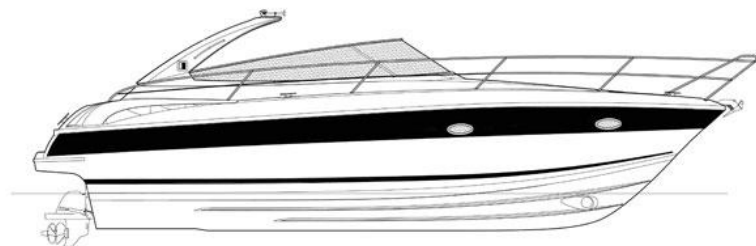

Length Overall	11.95m
Length Hull	11.77m
Beam overall	3.99m
Height above waterline	approx 3.07m
Height in Cabin	approx 1.90m
Draught, outdrive lowered	approx 0.95m
Draught, outdrive raised	approx 0.75m
Cabins	2
Berths	4
Unladen weight (inc engine)	from approx 8500kg
Fuel Tank	approx. 720ltrs
Water Tank	approx. 250ltrs
Persons	Max: 12

Petrol Engines	2 x Volvo Penta 5.7 GXI DPS Duoprop (inc prop) 239kw/320hp
or	2 x Mercruisers 350 mag DTS BEIII (inc electric shifting) 224kw/300hp AXIUS as option

Diesel Engines	2 x Volvo Penta D4-300 EVC DPS Duoprop (inc prop) 220kw/300hp
or	2 x Volvo Penta D6-330 EVC DPH duoprop (inc prop) 237kw-322hp

External Pictures



Internal Pictures



Standard Specification

Hull

Hull windows to open

Steering Wheel

Steering wheel in carbon design, height adjustable

Bow

Electric windlass with anchor & chain

Delta anchor zinc coated

Stainless steel bow fitting with anchor roller

Anchor chain, zinc coated 0.8mm, 50 metres

Deck

Radar arch GRP

Roof Lights

Anchor box, self-drained

6 Stainless steel cleats

Stainless steel bow rail

Stainless steel handrail and handrail on radar arch

Bathing Platform

Teak on bathing platform

Bathing platform with bathing ladder (telescopic)

Stern shower, cold and warm water (prepared)

Cockpit

Wet bar with sink

Cockpit, self drained

Cockpit light integrated in radar arch or hardtop

Windscreen wiper

Windscreen (security glass)

Illuminated compass

Helm stand with single seat

Settee and sun pad with upholstery in quality white

Marine quality cockpit upholstery, white

Cockpit table GRP

Cabin sliding door, tinted glass

Cabins

Two single berths, convertible to double berth

Double berth in foreship

Cabin

Reading lamp

Mahogany interior, massive and veneer

U-shaped settee

Standard upholstery

Stowage space

Locker and racks

Stowage space

Stowage space under sitting area

Stowage under aft sun pad

Overhead locker and wardrobe

Galley

Cutlery drawer

2 flame alcohol and electric burner

Refrigerator 12v, 80 litres

Stainless steel sink with cover

Miscellaneous

CE fire extinguishing system

2 fire extinguisher

Fire blanket

Transportation cover

Ventilation flaps for transportation cover

(winter storage)

Electrical engine bay cover

Engine bay fan

CE Category B

CE Certification

Water supply

Electrical pressurized water pump with filter

Toilet

Pump toilet with holding tank, disposal via seacock and deck suction

Bilge Pump

Electrical bilge pump in aft cabin

Instrumentation

Analogue instrumentation, speed, depth, engine temp., engine counter, power trim, voltmeter, rev metre, multi functional display

Electrical system

AC outlet package (1 per cabin and 2 in galley)

Shore supply 230v

Starter battery 88ah, 135ah depending on motorization (1 x per engine)

Additional battery 135ah

Main switch for batteries

Navigation

Navigation lights (BDI)

Horn

Individual Options

Bow Thruster

Bow thrusters SE60, electric (only in combination with 2nd service battery)

Bow thrusters SE80, electric (only in combination with 2nd service battery)

Deck

Teak on side deck

On Deck

Cup holder, stainless steel in foredeck

Sun upholstery (only in combination with cup holder, stainless steel in foredeck)

In harbour cover

Cockpit

Cockpit grille 230v

Teak on cockpit floor

Teak cockpit table

Refrigerator in cockpit 12v

Head

Shower in head with shower room separation

Cabin

Carpet in cabin

Pantry

Ceramic stove top

Microwave with grille

Miscellaneous

Steel cradle for over sea transport

Hot air heating 3.5kw for diesel (not possible in combination with air-conditioning/heating unit.

Air condition/heating unit

Warm water

Warm water boiler 20ltrs engine cooling circuit & via 230v shore supply

Toilet

Electric sea toilet with holding tank, disposal via seacock & deck suction

Engine

Axius drive for Mercruiser

EVC electronic shift for double engines/only for Volvo Penta, standard for D4 and D6

Electrical trim flaps

Electrical System

2nd additional battery 135ah

Battery charger, 45A (3 channel)

Gasoline generator 230v(4.5kw) or 110v (3.8kw)

Multimedia

TV 19" in salon with DVD

TV cabling inc. antenna and outlets

Radio with CD/MP3 player and 2 speaker in salon

2 speaker in cockpit

Navigation

VHF cabling inc. Antenna

Raymarine autopilot

Chart Plotter Raymarine C80 with GPS

Raymarine ST60 Tridata

Raymarine Radar

These are just a selection

Please contact us for full optional list, delivery and commissioning costs

Tel: 01803 853843

Email: sales@plainsailing.co.uk