

*“Rumrunner”*  
 Bavaria 34

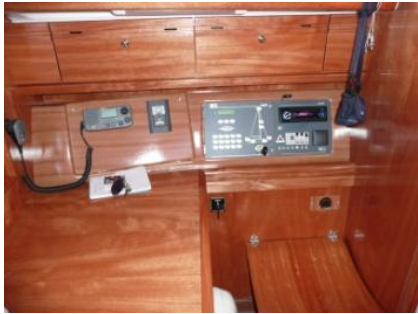

<b>Berths: 6 in 2 Cabins + Saloon</b>	<b>Length: 34'/10.71m</b>	<b>Age: 2009</b>	<b>Wheel/Fin Keel</b>
<b>Navigation. Equipment:</b>	<b>Full Raymarine Package</b>		
<b>Sails and Rigging</b>	<b>Main Sail with Slab Reefing, Furler Genoa</b>		
<b>Accommodation::</b>	<b>Sleeps 6 in 2 Cabins. Forward &amp; Aft Cabins, Comfortable Saloon, Galley with Cooker and Oven</b>		
<b>Unique to Bavaria Cruisers</b>	<b>Electrically Lowerable Bathing Platform (Incl Bathing Platform)</b>		

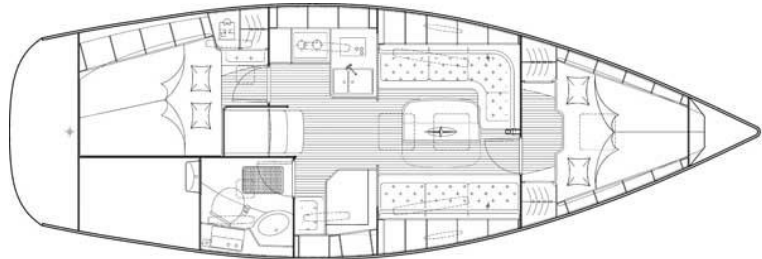