

Bavaria 47 Technical Details

<i>Specification</i>	
Length Overall	14,49m
Length of Hull	13,99m
Waterline Length	n.n
Beam overall	4,39m
Standard Draft	approx. 1,88m
Draft Option	n.n.
Unladen weight	approx. 11,300
Ballast	approx. 3,400kg
Engine Volvo Penta D2-55	39kw/53hp
Water Tank	approx. 790 ltrs
Fuel Tank	approx. 320 ltrs
Cabins/Berths	3/6 or 4/8
Mainsail & Genoa	approx. 127,40sqm
Height of Mast:	approx. 20,55m
Height in Saloon	approx. 2,05m

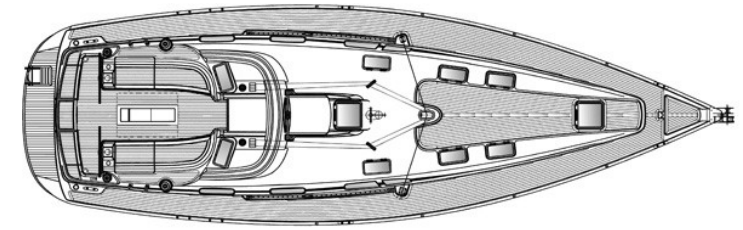

Deck

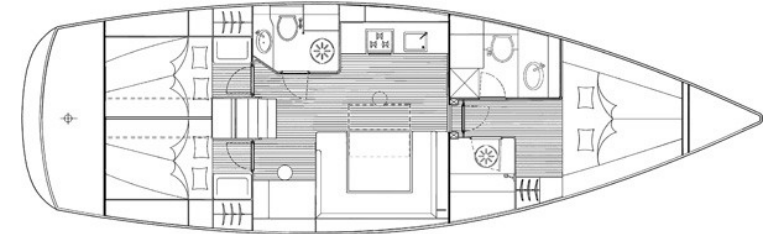

3 Cabin Layout

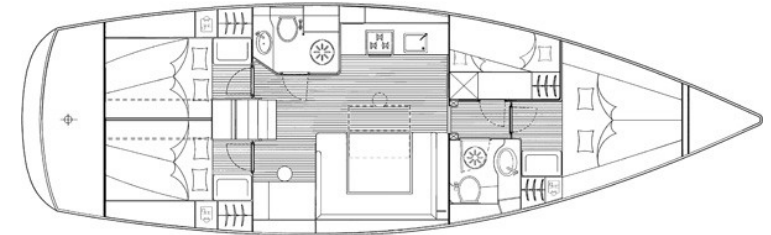

4 Cabin Layout



STANDARD EQUIPMENT FITTED ON ALL NEW BAVARIAS	
Teak flooring and on cockpit seats	Shore supply (excludes shore cable)
Headsail reefing system	Hot and cold water supply (including immersion heater)
Self tailing halyard & sheet winches	Shower in heads
Manual and electric bilge pumps	Holding tank for heads (with seacock and deck disposal)
Cockpit table—with stowage	Refrigerated cool box (12v)
Shower on bathing platform	Gimballed gas cooker with oven
Swimming/boarding ladder	